

ALL IN

real estates

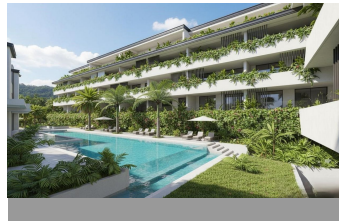

Ground Floor Apartment in Mijas Costa

Bedrooms **2** Bathrooms **2** Built **97m2** Terrace **22m2**

R5255971

**Ground Floor
Apartment**

Mijas Costa

499.000€

New Development: Prices from €499,000 to €950,000. [Bedrooms: 2] [Bathrooms: 2] [Built size: 97m2 - 110m2]. This new exclusive development is an apartment complex consisting of sixty-three homes arranged across three contemporary blocks on the first line of the golf course in Mijas Costa. Each block contains four levels: the ground-floor, first-floor, and second-floor apartments all offer 115 square meters of interior space plus a 22-square-meter terrace, while the penthouses provide 130 square meters of interior space along with their own terraces, each differing in size. The development also offers a selection of amenities designed to enrich everyday life. Each block includes its own underground parking. Residents can enjoy a fully equipped gym, a dedicated spa area for quiet moments of relaxation, and a large central pool set within wide, open green spaces. Surrounded by the first line of golf, the entire community is wrapped in natural beauty, with trees, flowers, and landscaped gardens creating a calm, refreshing environment at every turn. Each apartment offers two rooms and two bathrooms, arranged with a sense of balance and comfort that suits both everyday living and modern design. The main living area opens directly toward the terrace, with wide glass doors that bring in the light and frame the sea beyond. The space is finished with refined materials and warm neutral tones, giving the room a calm, high-end feel. Everything has been selected to work together: the layout, the finishes, the natural light, creating a salon that feels

elegant, spacious, and unmistakably contemporary. The bedrooms offer the same sense of calm and quality found throughout the apartment. Both rooms are designed with generous space, built-in wardrobes, and a clean, modern finish that keeps the atmosphere warm and organised. The main bedroom opens directly onto the terrace, allowing natural light to fill the space from morning to evening. The two bathrooms are finished with high-standard materials and soft lighting that give the spaces a refined, almost spa-like feel. Together, the bedrooms and bathrooms add a layer of comfort and practicality that completes the home.

Access for people with reduced mobility

Double Glazing

Gym

Access for people with reduced mobility

Ensuite Bathroom

Lift

Covered Terrace

Fitted Wardrobes

Private Terrace